

Female Swivel 60° Cone With Swivel Nut

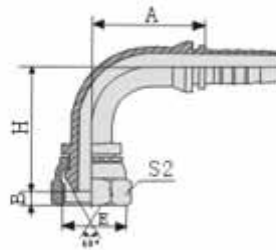

21691-90°NPSM Female Swivel 60° Cone With Swivel Nut SAE J514

Material: low or medial Carbon steel.

Surface treatment: trivalent or hexavalent chromium passivating Zinc (CR3+ or CR6+).

Inner packing: Plastic bag.

Outer packing: Standard exporting carton, seaworthy pallet.

Lutong is specialized in supply of hydraulic hose fittings with good quality and favorable price.

Technical Data

PART NUMBER	SCREW THREAD E	HOSE BORE		DIMENSIONS			
		DN	DASH	A	C	H	S2
15641-04-04	1/4°x18	6	04	30	4 . 6	40 . 5	19
15641-06-04	3/8°x18	6	04	30	6	37 . 7	22
15641-06-05	3/8°x18	8	05	34	6	40 . 7	22
15641-06-06	3/8°x18	10	06	35 . 3	6	45 . 3	22
15641-08-08	1/2°x14	12	08	41	7 . 5	53 . 2	27
15641-12-10	3/4°x14	16	10	56 . 5	8 . 9	53 . 5	32
15641-12-12	3/4°x14	20	12	65 . 5	8 . 9	69 . 1	32
15641-16-12	1°x11 . 5	20	12	65 . 5	10 . 5	64 . 5	41
15641-16-16	1°x11 . 5	25	16	76 . 7	10 . 5	75	41
15641-20-20	1 . 1/4°x11 . 5	32	20	91 . 5	11 . 2	86	50
15641-24-20	1 . 1/2°x11 . 5	32	20	91 . 5	11 . 2	83 . 5	55
15641-24-24	1 . 1/2°x11 . 5	40	24	109 . 4	11 . 2	101 . 5	55
15641-32-32	2°x11 . 5	50	32	131 . 8	11 . 2	124 . 5	70

Note:1. For use with braided hoses 2 . If use with spiral hoses, hose fitting series number is 21692x-xx.