

Banjo bolts

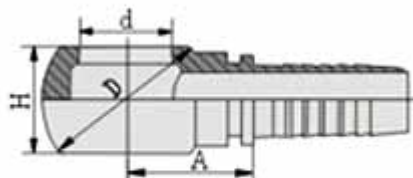

72011-BSP Banjo

Material: low or medial Carbon steel.

Surface treatment: trivalent or hexavalent chromium passivating Zinc (CR3+ or CR6+).

Inner packing: Plastic bag.

Outer packing: Standard exporting carton, seaworthy pallet.

Lutong is specialized in supply of hydraulic hose fittings with good quality and favorable price.

Technical Data

Part Number	Screw Tread E	Hose Bore		Dimensions			
		DN	Dash	A	d	D	H
70011-02-03	G1/8"×28	5	03	18	9.9	22	16
70011-02-04	G1/8"×28	6	04	18.5	9.9	22	16
70011-04-03	G1/4"×19	5	03	19	13.3	24	15
70011-04-04	G1/4"×19	6	04	19.5	13.3	24	15
70011-04-05	G1/4"×19	8	05	19.5	13.3	24	15
70011-04-06	G1/4"×19	10	06	19.5	13.3	24	15
70011-06-04	G3/8"×19	6	04	22	16.7	29	20
70011-06-05	G3/8"×19	8	05	22	16.7	29	20
70011-06-06	G3/8"×19	10	06	22	16.7	29	20
70011-06-08	G3/8"×19	12	08	23	16.7	29	20
70011-08-05	G1/2"×14	8	05	27.5	21	38	25
70011-08-06	G1/2"×14	10	06	27.5	21	38	25
70011-08-08	G1/2"×14	12	08	28	21	38	25
70011-08-10	G1/2"×14	16	10	29	21	38	25
70011-10-10	G5/8"×14	16	10	28	23	40	27
70011-12-10	G3/4"×14	16	10	32	26.5	48	31

70011-12-12	G3/4"×14	20	12	32	26.5	48	31
70011-16-08	G1"×11	12	08	40	33.3	60	42
70011-16-12	G1"×11	20	12	40	33.3	60	42
70011-16-16	G1"×11	25	16	41	33.3	60	42