

Flange

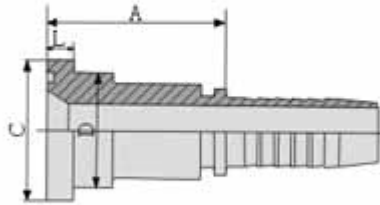

87611-SAE Flange 6000PSI ISO12151-3--SAEJ516

Material: low or medial Carbon steel.

Surface treatment: trivalent or hexavalent chromium passivating Zinc (CR3+ or CR6+).

Inner packing: Plastic bag.

Outer packing: Standard exporting carton, seaworthy pallet.

Lutong is specialized in supply of hydraulic hose fittings with good quality and favorable price.

Technical Data

PART NUMBER	FLANGE SIZE	HOSE BORE		DIMENSIONS			
		DN	DASH	A	C	D	L
87611-08-08	1/2°	12	08	47	31.7	24	7.75
87611-12-10	3/4°	16	10	51	41.3	32	8.76
87611-12-12	3/4°	20	12	51	41.3	32	8.76
87611-16-12	1°	20	12	58	47.6	38	9.53
87611-16-16	1°	25	16	57	47.6	38	9.53
87611-16-20	1°	32	20	61	47.6	38	9.53
87611-20-16	1.1/4°	25	16	65	54	44	10.29
87611-20-20	1.1/4°	32	20	66	54	44	10.29
87611-24-20	1.1/2°	32	20	75	63.5	51	12.57
87611-24-24	1.1/2°	40	24	75	63.5	51	12.57
87611-32-24	2°	40	24	85	79.4	67	12.57
87611-32-32	2°	50	32	85	79.4	67	12.57

Note: 1. For use with braided hoses 2 . If use with spiral hoses, hose fitting series number is 87612-xx-xx.