

JIS

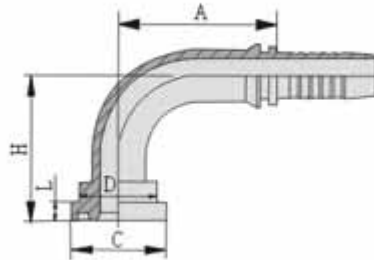

99191-90° JIS Flange

Material: low or medial Carbon steel.

Surface treatment: trivalent or hexavalent chromium passivating Zinc (CR3+ or CR6+).

Inner packing: Plastic bag.

Outer packing: Standard exporting carton, seaworthy pallet.

Lutong is specialized in supply of hydraulic hose fittings with good quality and favorable price.

Technical Data

Part Number	Screw Thread E	Hose Bore		Dimensions				
		DN	Dash	A	C	D	H	L
99191-10-08	5/8 "	12	08	41	34.2	27.8	48	6.7
99191-10-10	5/8 "	16	10	56.5	34.2	27.8	52.5	6.7
99191-10-12	5/8 "	20	12	65.5	34.2	27.8	62	6.7