

Flange

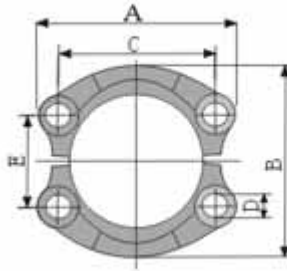

FL-SAE Split Flange Clamps 3000PSI ISO6162--SAEJ518

Material: low or medial Carbon steel.

Surface treatment: trivalent or hexavalent chromium passivating Zinc (CR3+ or CR6+).

Inner packing: Plastic bag.

Outer packing: Standard exporting carton, seaworthy pallet.

Lutong is specialized in supply of hydraulic hose fittings with good quality and favorable price.

Technical Data

| PART NUMBER | FLANGE SIZE | DIMENSIONS | | | | | BOLT | Pressure(Mpa) |
|-------------|-------------|------------|--------|--------|--------|--------|--------|---------------|
| | | A | B | C | D | E | | |
| FL-08 | 1/2° | 53 . 8 | 46 . 1 | 38 . 1 | 9 | 17 . 5 | M8x25 | 34 . 5 |
| FL-12 | 3/4° | 65 | 52 . 4 | 47 . 6 | 11 | 22 . 2 | M10x30 | |
| FL-16 | 1° | 69 . 9 | 58 . 7 | 52 . 4 | 11 | 26 . 2 | M10x30 | |
| FL-20 | 1.1/4° | 79 . 2 | 73 | 58 . 7 | 11 | 30 . 2 | M10x30 | 27 . 6 |
| FL-24 | 1.1/2° | 93 . 7 | 82 . 6 | 69 . 9 | 13 . 5 | 35 . 7 | M12x35 | 20 . 7 |
| FL-32 | 2° | 101 . 6 | 96 . 8 | 77 . 8 | 13 . 5 | 42 . 9 | M12x35 | |
| FL-40 | 2.1/4° | 114 | 109 | 88 . 9 | 13 . 5 | 50 . 8 | M12x40 | 10 |

Note: Bolt should be ordered in addition.